

EVENTS









pullman

HOTELS AND RESORTS

DUBAI CREEK CITY CENTRE



MEETING ROOMS CAPACITY

ROOM NAME	SURFACE (m ²)	HEIGHT (m)	 BOARDROOM	 U-SHAPE	 CLASSROOM	 THEATRE	 COCKTAIL	 BANQUET	 CABARET
BOARD ROOM 1	32.40	3.50	14	-	-	-	-	-	-
BOARD ROOM 2	78.60	3.50	24	-	-	-	-	-	-
KALIMAT	113.59	3.00	30	26	40	90	60	50	25
TAWASUL 1	91.20	4.00	24	22	32	80	50	50	30
TAWASUL 2	91.20	4.00	24	22	32	80	50	50	30
TAWASUL 3	91.20	4.00	24	22	32	80	50	50	30
TAWASUL 1+2+3	273.60	4.00	-	70*	120*	200	200	170*	90*-130
IDRAK 1	104.12	3.00	24	20	30	70	50	40	25
IDRAK 2	91.88	3.00	24	20	30	70	50	40	25
IDRAK 1+2	196.00	3.00	-	-	60	120	100	80	60
IRTIBAT	95.76	3.00	24	22-30	32	70	50	50	25-30

FLOOR PLAN

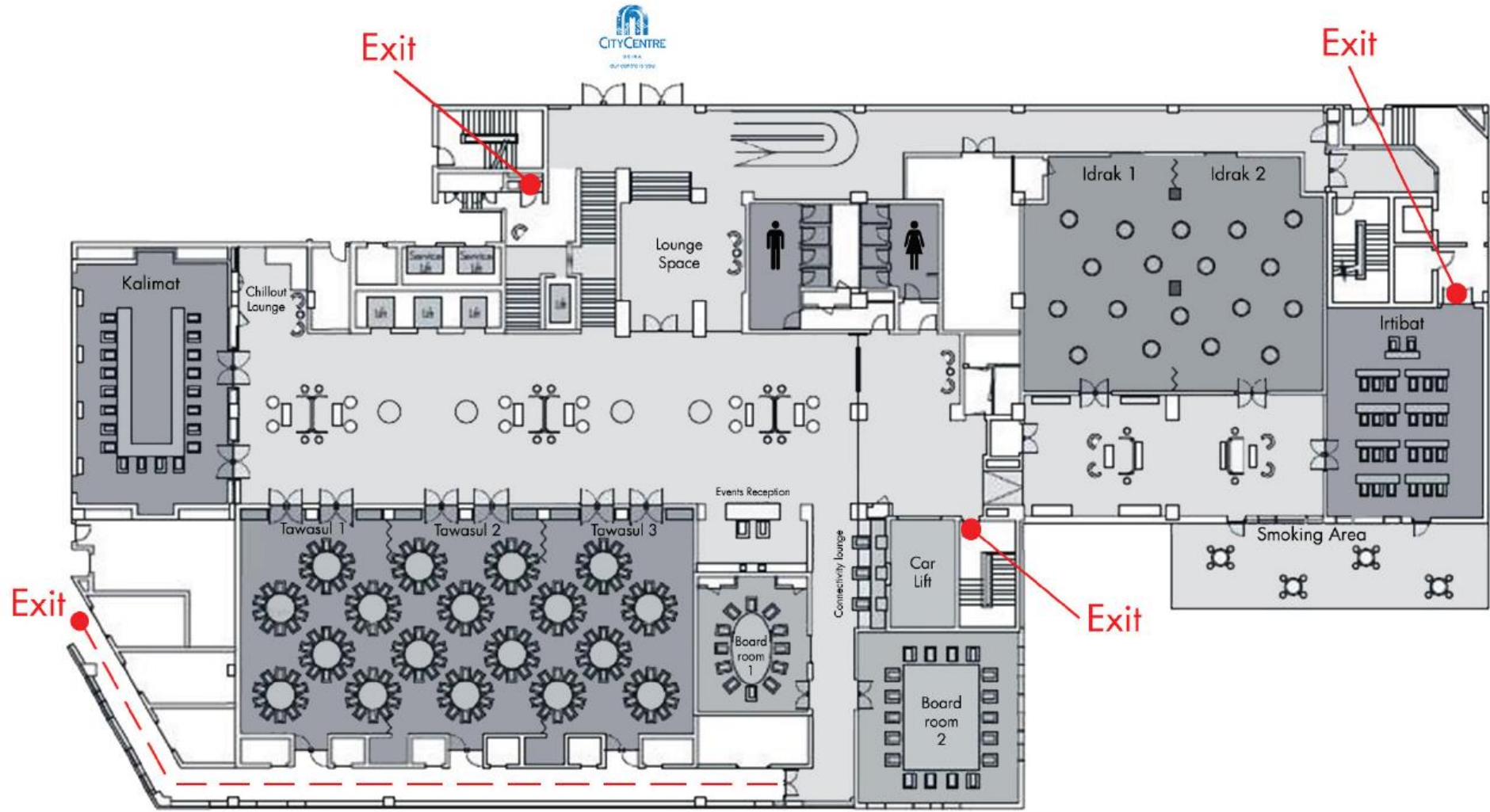

TAWASUL PRE-FUNCTION AREA



BOARDROOM 1



BOARDROOM 2



IDRAK 1 – CLASSROOM SETUP



IDRAK 2 – U-SHAPE SETUP



KALIMAT – THEATER SETUP



IRTIBAT – U-SHAPE SETUP



TAWASUL BALLROOM – WEDDING SETUP



TAWASUL BALLROOM – THEATER SETUP



TAWASUL BALLROOM – CLASSROOM SETUP



TAWASUL BALLROOM – CABARET SETUP



CREATIVE MICE CONCEPTS – TAKE ME TO THE BALL GAME



CREATIVE MICE CONCEPTS – JUICE UP



CREATIVE MICE CONCEPTS – CHOCOLATE!

